

EQUIPPED CYLINDER HEAD FOR CURSOR

***GENUINE PARTS
A SERVICE BY AMS***

Assembled for service!

We are now glad to inform that we extend the offer to the Equipped Cylinder Head already mounted by production plant to grant an even more perfect fit to your machines.

We offer 7 new cylinder heads equipped with all necessary components to fit on the engine with the benefit of 1 hour less installation time in the workshop versus the naked cylinder head plus its components. Equipped cylinder heads, manufactured by FPT, cover Cursor 9, Cursor 10, Cursor 13 and Cursor 16 engines fitted to FPT applications.

The equipped cylinder head incorporates components fitted at factory that usually have to be ordered separately from naked cylinder head.

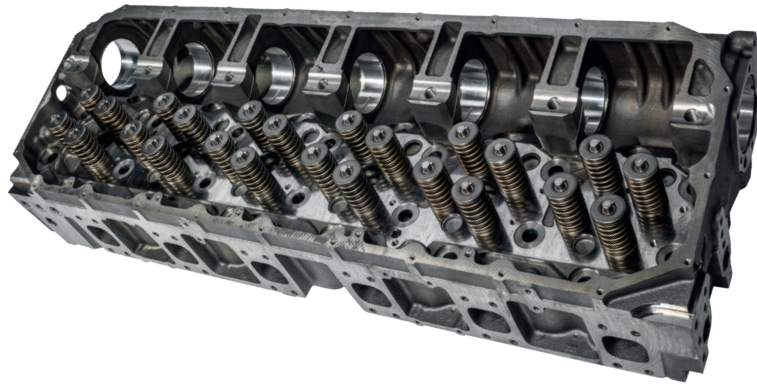

Designed to fit your engine perfectly, FPT Genuine Parts combine convenience, reliability and quality.

By servicing your vehicle with FPT parts, you'll boost your performance and extend your vehicle lifespan, while enjoying the reassurance of high-quality components and enhanced safety.

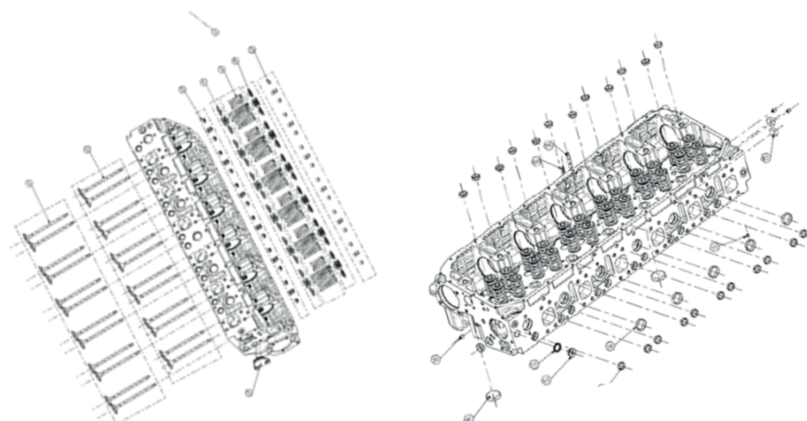

The cylinder head plays an important role in the combustion process enabling air and fuel to reach the cylinder, and exhaust gases to escape.

Furthermore, during manufacturing processes the cylinder head undergoes painting and cleaning operations to remove physical impurities that can obstruct the oil filter and/or alter viscosity of the engine oil (causing possible engine breakdown).

The cylinder head is one of the more complex engine components and it is subjected to several quality checks (e.g. leakage, pressure, temperature and tolerance test) to grant the engine's efficiency and to avoid also harmful deformations on other engine components.

ECH p n	Application	FamCl a
5802540644 C9	Power Gen - Off Road	AB11
5802540629 C9	Marine - Off Road	
5802530447 C10	On Road - Off Road	
5802530163 C13	Off Road	
5802492694 C13	Power Gen - Off Road	
5802530369 C13	Power Gen - Marine	
5802530372 C16	Power Gen	

Components fitted in each equipped cylinder head:

- Naked Cylinder head
- Injector case
- Valve Guide Intake and Exhaust
- Valve Seat
- Bushes, plugs and o-rings
- Valve Intake and Exhaust
- Springs
- Valve Cone

Pricing and Discount Class

ECH pn	List price	Discount	Net vs Sum of components A1
5802540644 C9	4.307,69 €		-16,0%
5802540629 C9	4.307,69 €		-39,4%
5802530447 C10	4.615,38 €		-30,7%
5802530163 C13	4.923,08 €	S	-24,3%
5802492694 C13	4.923,08 €		-33,7%
5802530369 C13	4.923,08 €		-37,9%
5802530372 C16	6.692,31 €		-29,4%

Our Service, Your Advantages

- | | |
|---------------------------------------|--|
| Fit as a Single Part | Assembled for service cylinder head equipped with all necessary parts |
| Optimized Ordering Process | Saving time in the process and avoiding mistakes |
| Supply and Logistic Management | Advantages in supply and logistic and in warehouse management, ordering one single PN instead of several ones (up to 26) |
| Save Time and Money | 1 hour saving vs assembling components
Up to 39,4% net price reduction vs all components |



AFTERMARKET SOLUTIONS BY FPT INDUSTRIAL